

Agenda 15b)

D + L
4111 / 24

From: Jenna Pegg <Jenna.Pegg@cornwall.gov.uk>

Sent: 10 October 2024 10:30

To: Cornwall Highways Enquiries <enquiries@cornwallhighways.co.uk>; Cornwall Streetworks <streetworks@cornwall.gov.uk>; Streetlighting <streetlighting@cornwall.gov.uk>; Land Charges (Caradon) <landcharges.east2@cornwall.gov.uk>; Localism <localism@cornwall.gov.uk>; Cornwall Council - Waste Management <wastemanagement@cornwall.gov.uk>; Countryside Access - Registered Common Land, Definitive Maps and Changes to the Rights of Way Network <countrysideaccess@cornwall.gov.uk>; Address Management Team (Cornwall) <addressmanagement@cornwall.gov.uk>; Highway Adoption Notifications <adoptionnotifications@cornwall.gov.uk>; GIS Mailbox <gis@cornwall.gov.uk>; Milly Southworth <admin@torpointtowncouncil.gov.uk>; Cllr John Tivnan <cllr.john.tivnan@cornwall.gov.uk>

Subject: Dedication of ~~Gurney Close~~, Torpoint

Adams Crescent

Information Classification: CONTROLLED

Land Charges
SENT BY EMAIL ONLY:
landcharges.county@cornwall.gov.uk

Your ref:
My ref: 639/40
Date: 10 October 2024

Dear Sirs

Highway dedication of Adams Crescent, Torpoint

Please accept this letter as confirmation that Cornwall Council, as the registered freehold owner of the land coloured pink on the enclosed plan, title number CL13611, now dedicate the area for use as a highway verge.

Please can your records be updated to show as a highway maintainable at the public expense, designation as highway verge.

Yours faithfully



Sharon Bundy
Strategic Development Lead
Environment & Connectivity Service
Tel: 0300 1234 222
Email: strategicdevelopment@cornwall.gov.uk

Adams Crescent, Torpoint

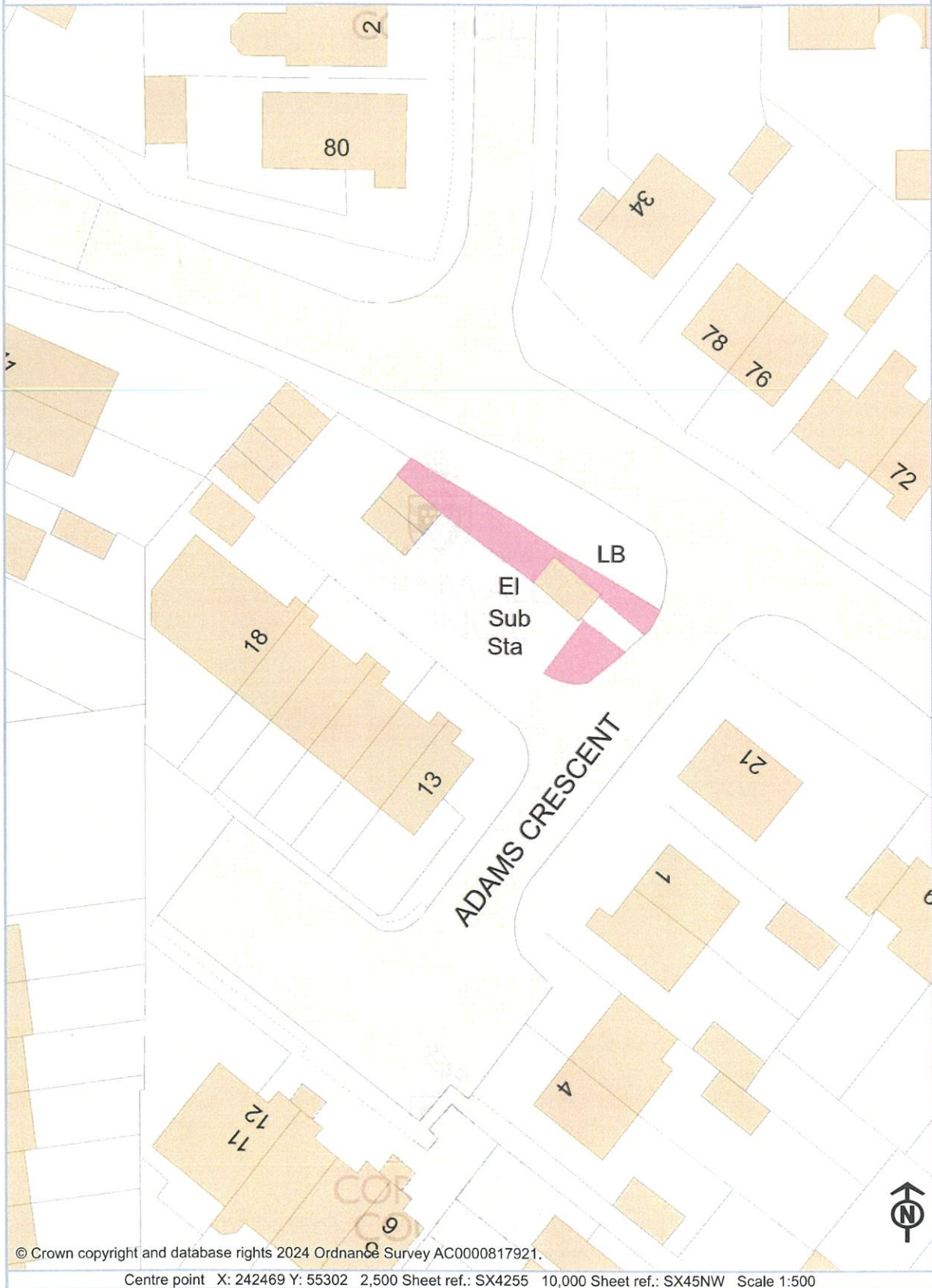

© Crown copyright and database rights 2024 Ordnance Survey AC0000817921.

Centre point X: 242469 Y: 55302 2,500 Sheet ref.: SX4255 10,000 Sheet ref.: SX45NW Scale 1:500