

Milly Southworth

From: Torpoint Town Council <admin@torpointtowncouncil.gov.uk>
Sent: 16 May 2024 11:45
To: Milly Southworth
Subject: FW: Cornwall Gateway CNA - Countywide 20mph Rollout
Attachments: Infra23-213-CG CSL Infrastructure Consultation Letter.pdf; Combined Site Notices.pdf

Harriet Bastin

Torpoint Town Council Support Officer

p. [01752 814165](tel:01752814165)

e. admin@torpointtowncouncil.gov.uk

w. www.torpointtowncouncil.gov.uk

a. 1-3 Buller Road Torpoint Cornwall PL11 2LD



From: Annan Birkett <annan.birkett@cormacltd.co.uk>

Sent: 15 May 2024 15:40

To: Cllr Kate Ewert <cllr.kate.ewert@cornwall.gov.uk>; Cllr John Tivnan <cllr.john.tivnan@cornwall.gov.uk>; Cllr Martin Worth <cllr.martin.worth@cornwall.gov.uk>; Cllr Hilary Frank <cllr.hilary.frank@cornwall.gov.uk>; Cllr Sheila Lennox-Boyd <cllr.sheila.lennox-boyd@cornwall.gov.uk>; Carolyn May <clerk@maker-with-rame-pc.gov.uk>; Karenza Heald <theclerk@millbrook-pc.gov.uk>; Milly Southworth <admin@torpointtowncouncil.gov.uk>; antonyparishcouncil@gmail.com; Nancy Gray <sheviockpc@btinternet.com>; Emily Young <clerk@stgermansparishcouncil.gov.uk>; Karenza Heald <clerk@landrakeparishcouncil.gov.uk>; Sinead Burrows <sinead.burrows@saltash.gov.uk>

Cc: Ian Findler <Ian.Findler@cornwall.gov.uk>; Adam O'Neill (Transport) <adam.1.oneill@cornwall.gov.uk>; William Glassup <william.glassup@cornwallhighways.co.uk>

Subject: Cornwall Gateway CNA - Countywide 20mph Rollout

Information Classification: PUBLIC

Good afternoon,

Please find the attached documents. These include the proposed speed limit amendments for the Cornwall Gateway CNA as part of the Countywide 20mph Rollout, alongside an explanatory letter. The consultation is live from today and will run until 7th June 2024. Erection of site notices will be completed by close of play today.

It would be helpful if you could all respond with your thoughts and suggestions on the scheme so that we may log your comments of support/objections.

Kind regards,

Annan

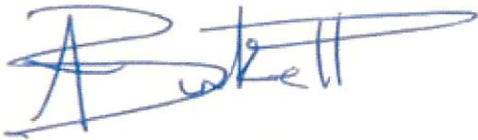

Annan Birkett FdSc EngTech MICE | Engineer/Project Manager

CORMAC | Infrastructure Design (Consultancy)

Murdoch Building – Zone 2, Western Group Centre, Radnor Road, Scorrier, Redruth, TR16 5EH

annan.birkett@cormacltd.co.uk | www.cormacltd.co.uk | 'Chat with me on Teams'



CORMAC Solutions Ltd - A Cornwall Council Company

Registered in England No. 07737430

Western Group Centre, Radnor Road, Scorrier, Redruth, TR16 5EH

This e-mail and attachments are intended for above named only and may be confidential. If they have come to you in error you must take no action based on them, nor must you copy or show them to anyone; please e-mail us immediately at info@corservltd.co.uk Please note that this e-mail may be subject to recording and/or monitoring in accordance with the relevant legislation and may need to be disclosed under the Freedom of Information Act 2000 or the Environmental Information Regulations 2004. Security Warning: It is the responsibility of the recipient to ensure that this e-mail and any attachments are virus free. Corserv will not accept liability for any damage caused by a virus. Corserv Solutions Ltd - A Cornwall Council Company Registered in England No. 07737430. Registered office: Western Group Centre Radnor Road, Scorrier, Redruth, Cornwall, England, TR16 5EH. Consider the environment; do you really need to print this email? Let us know if you need any assistance such as help with mobility, vision or hearing, or information in a different format.



Virus-free. www.avg.com



PART OF THE
CORSEV GROUP
A CORNWALL
COUNCIL COMPANY

Your ref:

My ref: Infra23-213-CG

Date: 14/05/24

Dear Sir/Madam,

Countywide 20mph Speed Limits – Phase 3 Cornwall Gateway

Cornwall Council intends to implement a 20mph Speed Limit on most residential streets within Antony, Cawsand, Craffhole, Kingsand, Landrake, Portwrinkle, Saltash, St Germans, Tideford, Torpoint and Trematon (in most locations the existing speed limit is currently 30mph). These settlements, which are part of the Cornwall Gateway Community Network Area, have previously expressed strong local support for this. Buffer zones will also be implemented leading up to these, where deemed necessary. Please see additional documentation for further details of proposed extents.

It is considered that implementing a reduced speed limit (20mph) on roads within these areas will make a major contribution towards improving road safety, especially for vulnerable road users, and traffic using these roads. This, in turn, will aid in the achievement of the Council's 'Vision Zero' goal – working towards the prevention of all fatal and serious injuries on the county road network.

The imposition of 20mph speed limits in these locations, should also improve the amenity of these areas and assist in encouraging a transition towards individuals using active travel, particularly for local journeys, resulting in increased journey time reliability and healthier communities. Severance by traffic will also be reduced, facilitating a greater use of local community facilities and enabling more liveable streets. As well as encouraging more social interaction, this may also be beneficial to the local economy.

The wider roll-out of 20mph speed limits is also likely to reduce noise and air pollution, via the reduced need for motor vehicles to use harsh breaking and/or acceleration, providing additional positive health benefits for both visitors and residents alike.





PART OF THE
CORSERY GROUP
A CORNWALL
COUNCIL COMPANY

To see which streets are covered by the proposed speed limits, plans showing the proposals can be viewed either online at www.cornwall.gov.uk/TrafficConsult or in person at New County Hall, Treyew Road, Truro, TR1 3AY.

If you have any comments to make on the proposals, I would be grateful to receive them no later than:

7th June 2024

To respond to this consultation, you can either:

1. Use Cornwall Council's Consultation finder, an on-line facility for viewing and responding to traffic consultations. This can be accessed by visiting www.cornwall.gov.uk/TrafficConsult. Once registered you will be able to submit responses to this and other current traffic consultations.
2. E-mail Infrastructure Design at traffic@cormacltd.co.uk, quoting the scheme name and reference, and indicating your support or objection to the proposals.
3. Respond in writing using the attached Consultation Response Form, indicating your support or objection to the proposals. Please return the form to the address shown at the foot of it.

If you wish to discuss any aspect of this scheme, please do not hesitate to contact me.

Yours sincerely

Annan Birkett
Project Manager/Engineer
Cormac Infrastructure (Regulatory)
Tel: 01872 327 250
Email: traffic@cormacltd.co.uk



PART OF THE
CORSERV GROUP
A CORNWALL
COUNCIL COMPANY

Infrastructure Design Consultation Response Form

Scheme Name: Countywide 20mph Speed Limits - Phase 3 – Cornwall Gateway CNA
Scheme Reference: Infra23-213-CG
Designer Name: Annan Birkett
Start of Consultation: 15/05/2024
End of Consultation: 07/06/2024

Title: Mr Mrs Miss Ms Other

Name:
Please print in block capitals

Organisation:

Address:

Postcode:

E-mail:

Date: / /
 DD MM YYYY

1. What is your view on this scheme? (please tick one) **Support** **Object**

2. Please use the box below to provide any comments you have with regards to this scheme. If you wish to object to the proposal, you **must** state your reasons for doing so.

Please continue overleaf if necessary

Please return this form to:

Infrastructure Design Western Group Centre,
Radnor Road, Scorrier, Redruth TR16 5EH
traffic@cormactd.co.uk





PART OF THE
CORSERV GROUP
A CORNWALL
COUNCIL COMPANY

Privacy Information

Cormac collects personal information from you when you register a consultation response. We will use this information to assist in collating feedback and to respond to you if we require clarification or further information on the response you have provided. The secure management of your information is very important to us and work has been undertaken to ensure that the Company is GDPR compliant.

Please note that any personal information collected from you as part of the consultation process will be securely destroyed within 12 weeks of completion of the scheme. However, you have the right to request that your information is removed at an earlier point, by using the contact details provided in this letter.

If you choose not to provide your address with your response or withdraw your personal information before completion of the scheme, we regret that we may be unable to consider your response in regard to a particular aspect of it. Nonetheless, any points made will still be considered as general comments.

You can find out more information about how your information is used, how we maintain the security of your data and your rights in regard to the information we hold about you on our website: <https://www.corservltd.co.uk/privacy-and-cookie-policy/>

If you have any other queries regarding the use of your data, you can contact the Data Protection Officer at Corserv Solutions Ltd, Western Group Centre, Radnor Road, Scorrier, Redruth TR16 5EH or phone 01872 323 313.



PROPOSAL

CORMAC Consultancy,
on behalf of Cornwall Council, is inviting comment on the following proposal
**Infra23-213 Countywide 20mph Speed Limits - Phase 3
Torpoint**



Date	Originator	Document ref.
25/04/24	TGT	Infra23-213_SN208

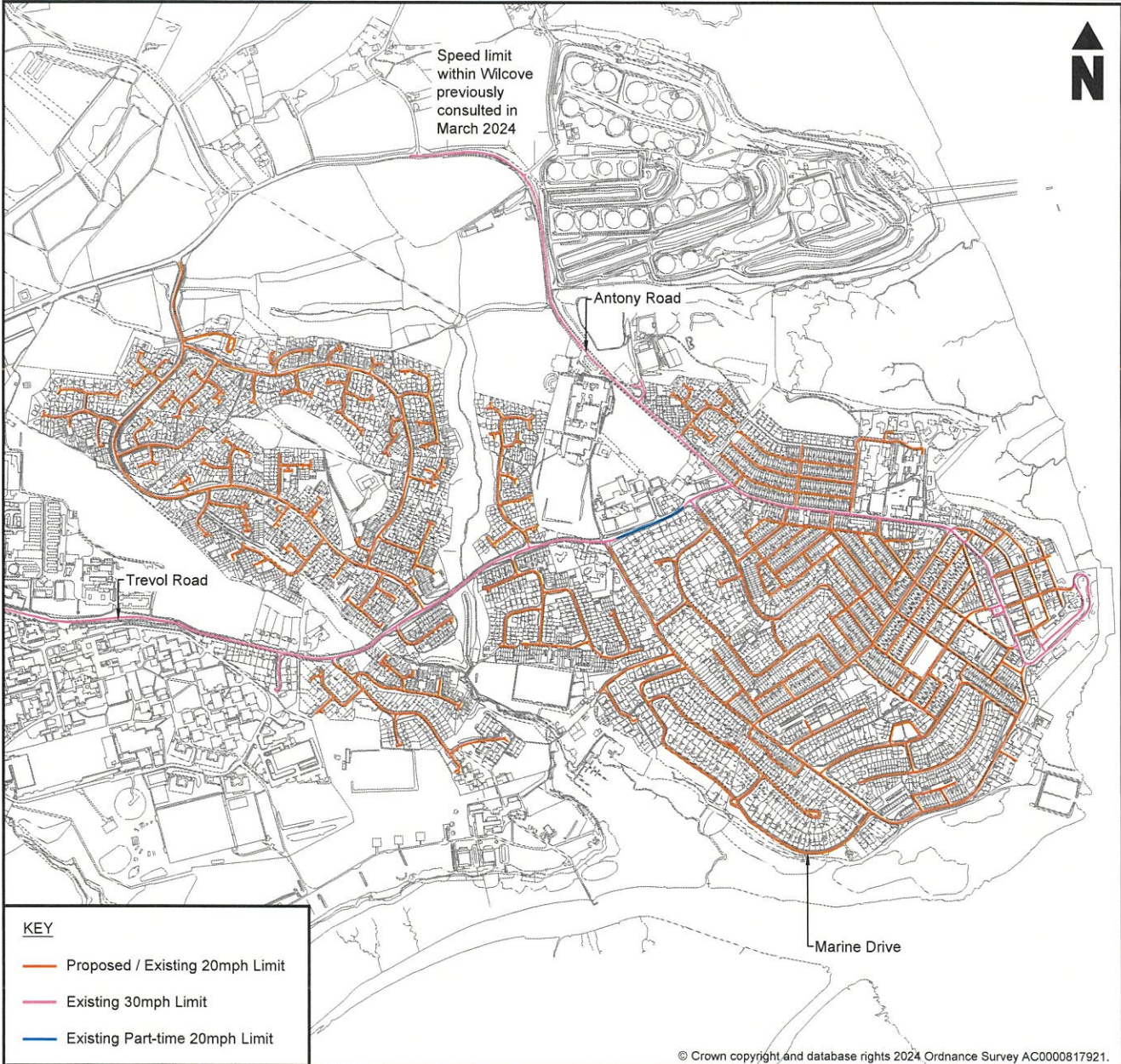

To respond, please send any comments or objections, specifying the grounds on which they are made, via email or in writing to:
**Infrastructure Design Group, CORMAC Consultancy,
Radnor Road, Scorrier, Redruth, TR16 5EH.**

Alternatively, please scan the QR Code to respond online using the Consultation Finder service or visit:

www.cornwall.gov.uk/TrafficConsult

To arrive no later than: **07/06/2024**

"QR Code" is a registered trademark of DENSO WAVE INCORPORATED.



Copies of the draft proposals and plans are available for public inspection during normal office hours at:

New County Hall, Treyew Road, Truro TR1 3AY

Please contact us using the details below to obtain further information.

Telephone:

01872 327 250

Email:

traffic@cormacltd.co.uk

Please quote reference:

Infra23-213_SN208

Privacy Notice

CORMAC Solutions Ltd requests personal information when you respond to this consultation for the purposes of collating feedback and/or responding to any comments received. This information is destroyed within 12 weeks of the scheme's completion, although you may request this earlier by contacting us. If you choose not to provide an address or other personal information, or withdraw these before the scheme's completion, we regret that we may be unable to consider your response in regards to a particular aspect of the scheme. In line with the GDPR you can find further details on how CORMAC may use any information you supply, how we maintain the security of your data and your rights in regard to the information we hold about you on our web-site: <https://www.corservltd.co.uk/privacy-and-cookie-policy/>

Please note that it may also be necessary to include any information you provide in publicly available documents or to disclose it to third parties under the Freedom of Information Act 2000 or the Environmental Information Regulations 2004. Please contact the below if you have any concerns or queries regarding the processing of your information.

Data Protection Officer, CORSERV Ltd, Western Group Centre, Radnor Road, Scorrier, Redruth, Cornwall, TR16 5EH

part II

Milly Southworth

From: Adam O'Neill (Transport) <adam.1.oneill@cornwall.gov.uk>
Sent: 29 May 2024 17:35
To: Cllr Kate Ewert; Cllr John Tivnan; Ian Findler; Catherine Thomson;
clerk@torpointtowncouncil.gov.uk; Gary Davis
Cc: William Glassup
Subject: Torpoint A374 30mph

Information Classification: CONTROLLED

Hi all,

Thanks again for the meeting, appreciate it wasn't the easiest, but hopefully we have a plan.

As discussed, the 30mph over-extension has increased speeds and so we would like to address that. It was really useful to understand why the 30mph was extended (Wilcove pedestrian safety accessing the school) and as a result, I've added a pedestrian refuge to the nomination list for Local Transport Plan funding (2025 onwards). That would actually address the safety concerns much better than a lower non-compliant speed limit.

We will check timescales for the development of the rugby pitch and will also check if there any proposals for changes on the A394, such as a crossing point.

Short term – We'll consider starting the 30mph roughly where my mouse is, in advance of the crossing point by the bend. Explaining the rationale behind the 30mph to 40mph will be key and we'll join this with the 20mph rollout, so it's coordinated. If the sign can't fit on the nearside (larger vehicle wing mirrors), the signs would need to go onto the existing posts instead. We'll confirm either way though:



Longer term – We'll aim for pedestrian crossing improvements in the below location (funded either by Local Transport Plan if successful, or via the proposed development). This will hopefully addresses the concerns for Wilcove residents:



Hope this helps and if you haven't already, just a nudge to respond to the 20mph consultation please. It closes next Friday.

Regards,

Adam O'Neill | Programme Development & Delivery Lead
Cornwall Council | Connectivity & Transport Policy | Economic Growth & Development
adam.1.oneill@cornwall.gov.uk | Tel: 01872 327228 and say my name
www.cornwall.gov.uk | 'Onen hag oll'

This e-mail and attachments are intended for above named only and may be confidential. If they have come to you in error you must take no action based on them, nor must you copy or show them to anyone; please e-mail us immediately at enquiries@cornwall.gov.uk. Please note that this e-mail may be subject to recording and/or monitoring in accordance with the relevant legislation and may need to be disclosed under the Freedom of Information Act 2000 or the Environmental Information Regulations 2004. Security Warning: It is the responsibility of the recipient to ensure that this e-mail and any attachments are virus free. The Authority will not accept liability for any damage caused by a virus.

