

## **ISO 14001 INSTALLATION SOIL CONDITIONS**

As part of the company's commitment to the environment we have achieved accreditation to ISO 14001.

Part of our policy regarding environmental issues addresses the land on which children's playgrounds are built. These areas must be free of any toxins and we must also be sure that any waste arising from the site can be safely disposed of by normal means.

It is the responsibility of the client to determine the suitability of land used for children's playgrounds and therefore your organisation/company we will be required to sign this form and return to our offices prior to work commencing on site.

**Roy Allcock**

**Managing Director**

---

### **Statement For The Determination of Soil Contamination For Proposed Play Area Construction**

I/we the undersigned, to the best of our knowledge, state that the soil conditions on which the playground is to be built are within the guidelines as laid down by the Interdepartmental Committee on the Redevelopment of Contaminated Land (ICRCL), copies of which are available from the Department of the Environment.

Any Soil not designated as safe for use will be dealt with as stated within the ICRCL guidelines, or removed from site and treated in accordance with current Waste Regulations.

**Company/Organisation:**

**Site:**

**Signed:**

**Date:**

**Name:**

**Designated:**

**(Please Print)**

A close-up photograph of green mulch, showing numerous thin, needle-like or leaf-like pieces of material in various shades of green.

**GREEN**

A close-up photograph of brown mulch, consisting of many small, irregular wood chips and bark fragments in various shades of brown.

**BROWN**

A close-up photograph of blue mulch, showing thin, needle-like or leaf-like pieces of material in various shades of blue.

**BLUE**

**ECOSURFACE STANDARD COLOUR OPTIONS**

A close-up photograph of black mulch, showing thin, needle-like or leaf-like pieces of material in various shades of black and dark grey.

**BLACK**

A close-up photograph of sand mulch, showing a mixture of small, irregular sand grains and wood chips in various shades of tan and brown.

**SAND**

A close-up photograph of khaki mulch, showing thin, needle-like or leaf-like pieces of material in various shades of khaki and light brown.

**KHAKI**

### Cambridge Field Works

Location of the large rope swing needs to move as it is a bit close to the existing 3 way springer. Considering either location A or B or an alternative location within the park being considered by the consultant.

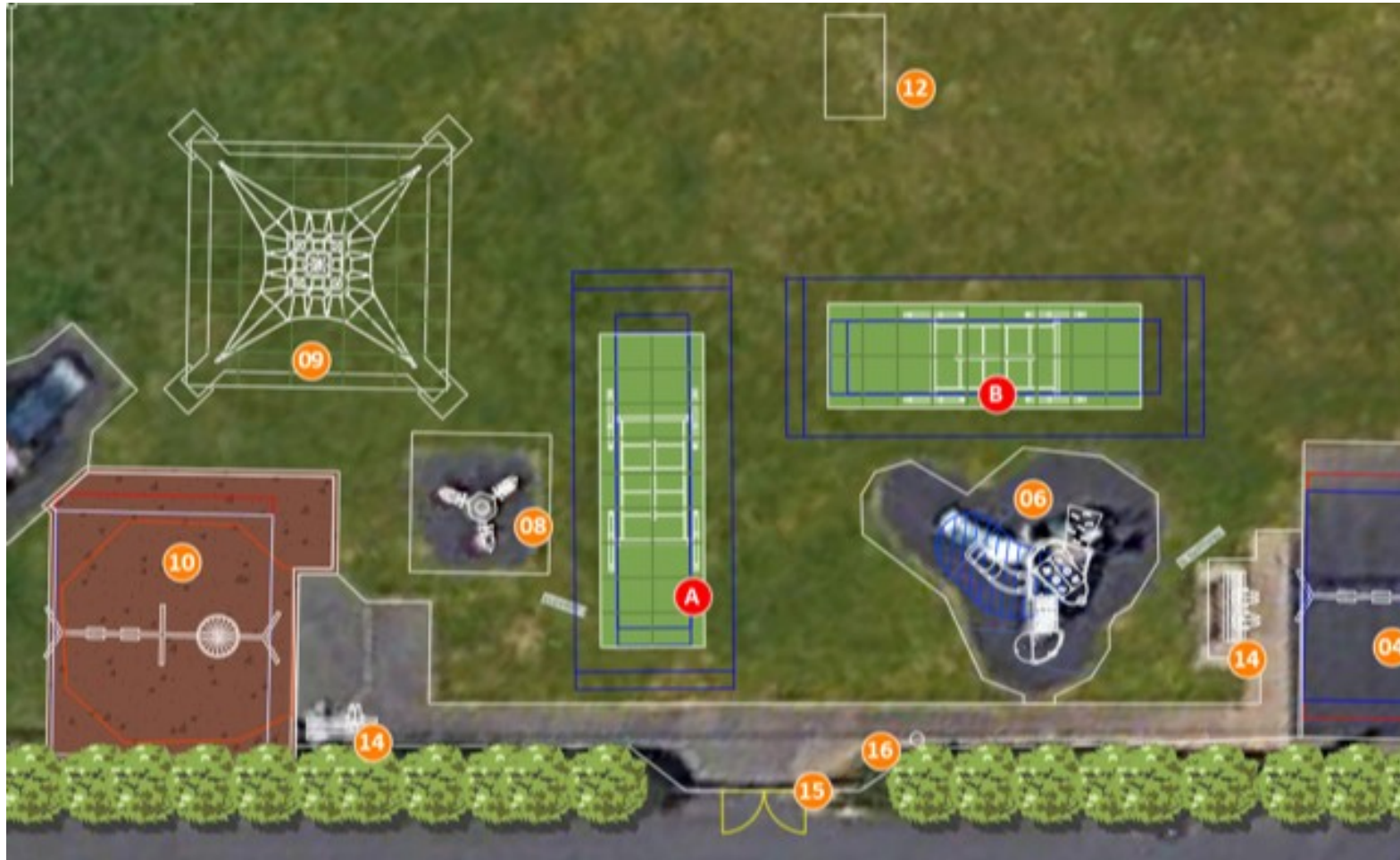

---

This is the agreed revision for the area to the right in terms of the surfacing from the site meeting (the 'infill with mulch' in blue writing is what is being offered at no extra cost).

The challenge all along were these small tarmac areas that are not perfect for a new playground, however there is a limited budget. Its only really aesthetics, and the main focus is the new equipment however perhaps something to think about.

I think there are two options: 1 is that we see if Sutcliffe can extend the surfacing to cover these two gaps shown which I cant see being a significant amount, or that it is part of Phase 2 to cover these up, or maybe even add in something small with surfacing in Phase 2.

- Sutcliffe have agreed to include some additional surfacing near the Supernova to effectively join the two areas over the existing tarmac which would not look great, so this will be a better finish at no extra cost.

